

文化 · 社區

exhibition

■ 空間 S



ISSN 1022-5609



9 771022 560001

衛殊+貝卓國際設計事務所
Reich+ Petch Design International

The Bug House at World Museum Liverpool
英國利物浦 Liverpool, United Kingdom
2,690 平方呎 / sq ft



The Bug House, Liverpool

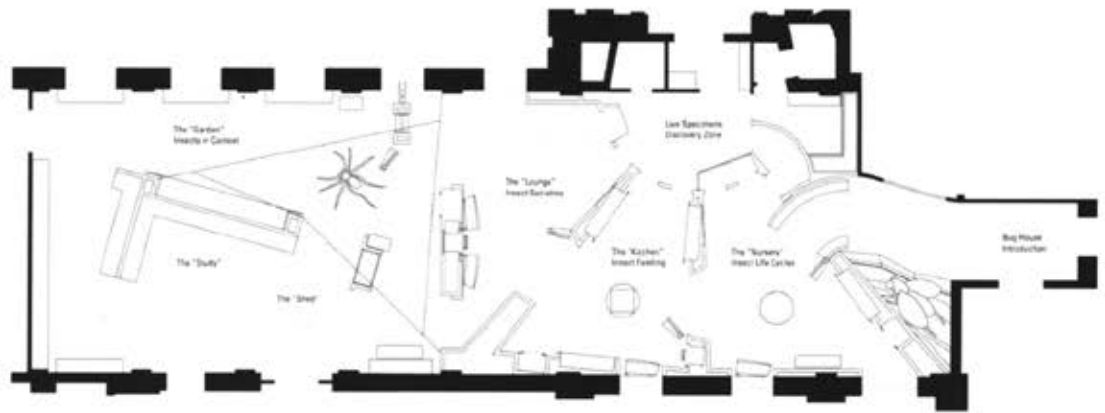

佈局圖 Layout plan

昆蟲對大部分人而言都是模樣噁心的小生物，只有極少數人敢去接近，更遑論呆在一個滿是昆蟲的「昆蟲屋」了。然而，「衛殊+貝卓」與 Jasper Jacob Associates 聯手合作，以通俗親切的設計手法創製了獨特的展廳體驗，幫助參觀者克服進入昆蟲世界的恐懼。

「昆蟲屋」是利物浦世界博物館裡的一個新昆蟲館，也是「衛殊+貝卓」為博物館設計的多個展廳之一，其他還包括世界文化廊(以亞洲、非洲、大洋洲和美洲的珍貴收藏品為特色)以及一所新水族館。

博物館收集了豐富的昆蟲藏品和研究標本，這些資料通常只有學者才有機會看到，現在卻向大眾公開展出，因此設計師必須營造友善而舒適的環境，讓參觀者可以充分享受徘徊在一萬八千件昆蟲標本間的樂趣。

當參觀者甫入展廳時，立刻被宏偉的入口所震撼。龐大的入口使參觀者顯得相對細小，好讓人們預備進入昆蟲的世界。在這裡，一隻巨型電子活動昆蟲緩緩蠕動，歡迎著參觀者進入展館。

當參觀者甫入展廳時，立刻被宏偉的入口所震撼。龐大的入口使參觀者顯得相對細小，好讓人們預備進入昆蟲的世界。此外，在入口處，一隻兩米高的電子活動昆蟲緩緩蠕動，歡迎著參觀者進入展館。
When a visitor first approaches, he / she would be struck by the "super-scaled" gallery entry, which was designed to effectively reduce visitors in size and transport them into the world of insects. A two-metre animatronic fly moves gently at the entry and welcomes visitors into the gallery.





Special bugs wall case panel



Dragonfly life cycle panel



為清晰準確地傳遞訊息，設計師使用簡易的說明圖像來闡釋展廳的主題。
To make the messages clear and easy to understand, illustrative graphics are used to present the themes and the topics of the gallery in a visitor-friendly manner.





為清晰準確地傳遞訊息，設計師使用簡易的說明圖像來闡釋展廊的主題。另一方面，巨型的昆蟲模型劃分出不同的區域。

除此以外，數個精巧的互動裝置有助表達複雜的題材。例如特大的「收音機」讓參觀者可以選擇不同的昆蟲叫聲，並從中學習不同品種的昆蟲如何發出這些聲音。巨型模型——包括了兩米高的電子活動蒼蠅及蟄伏在天花板上的蜘蛛網內以迎接客人的巨型蜘蛛——令展品陳列更加豐富，並為展廊注入愉悅的氣氛。

展廳還設有一系列特別為博物館而培養的活昆蟲，儲存在標本箱裡，好奇的參觀者可透過與場賞員溝通互動，探索有關活昆蟲的奧秘，這亦是本展覽的一大特色。

Insects, to many of us, are tiny creatures that have a frightening appearance. Few people dare to near them, not to mention to enter a "bug house" full of insects. However, with a friendly and popular design vocabulary, designers Reich + Petch, in association with Jasper Jacob Associates, help visitors overcome any fears in discovering the world of insects through a unique gallery experience.

The Bug House, a new entomology gallery, is one of the projects Reich + Petch has completed at World Museum Liverpool, including World Cultures Gallery (featuring remarkable collections from Asia, Africa, Oceania and the Americas) as well as a new aquarium.

(上) 展廳還設有一系列特別為博物館而培養的活昆蟲，儲存在標本箱裡，好奇的參觀者可透過與導賞員溝通互動，探索有關活昆蟲的奧秘。
(Top) For the truly inquisitive visitors, the gallery also houses a series of live specimen cases where they can interact with museum demonstrators and explore the secrets of living specimens that are specifically cultivated for the gallery.

(下) 互動的昆蟲「收音機」讓參觀者可以選擇不同的昆蟲叫聲，並從中學習不同品種的昆蟲如何發出這些聲音。
(Bottom) An interactive insect "radio" allows visitors to select different "bug sounds" and to learn how they are made by the different insect species.



The museum possesses a significant collection of insects and research specimens that was basically only available to scholars. Now, this worthy collection is open to the public. Therefore, a welcoming and cozy environment is created to make the visitors feel comfortable in the midst of 18,000 insect specimens.

When a visitor first approaches, he/she would be struck by the "super-scaled" gallery entry, which was designed to effectively reduce visitors in size and transport them into the world of insects. Here, a giant animatronics insect moves gently and welcomes visitors into the gallery.

To make the messages clear and easy to understand, illustrative graphics are used to present the themes and the topics of the gallery in a visitor-friendly manner while large-sized insect models define the different zones of the gallery.





巨型蜘蛛 Avril 在天花板上的蜘蛛網內迎接參觀者。
Avril, the giant animatronic spider, welcomes visitors from her web on the ceiling.

In addition, several impressive interactive devices help to communicate complex topics. For example, an oversize "radio" is set up to allow visitors to select different "bug sounds" and to learn how they are made by the different insect species. Larger-than-life models - including a two-metre animatronic fly and Avril the giant spider, who welcomes visitors from her web on the ceiling - enrich the display of the exhibits and instill the gallery with a delightful atmosphere.

Finally, for the truly inquisitive visitors, the gallery also houses a series of live specimen cases where they can interact with museum demonstrators and explore the secrets of living specimens that are specifically cultivated for the gallery.



客戶 Client
World Museum Liverpool

設計組 Project Team
Anthony Reich, Stephen Petri, Heather Chiao, Andrew Gibbs, Edmund Li, Michael Peters, Leonard Wyma, Sharon Ohno, Amanda Ramos, Carolina Chen, Lesley Carleton of Reich+ Patch Design International

總承辦商 Main Contractor
MICE / Sliver Knight

燈光顧問 Lighting Consultant
Sutton Vane Associates

燈具 Lighting Fixtures & Fittings
Track lighting by Erco

傢具 Furniture
MICE / Sliver Knight

鋪地 Flooring
Carpet by Interface

藝術品 Artwork
Animatronics / scientific sculptures by EDM

攝影 Photography
Kerun Ip

昆蟲屋在英國是獨一無二的，展示了來自博物館多個研究收藏品中的數千個標本以及動物飼養場裡活生生的節肢昆蟲。

The Bug House is unique in the UK in combining thousands of specimens from the museum's vast research collection with real live colonies of arthropods in vivariums.





Over 25 years, we have evolved our viewpoint about design to create extraordinary moments and opportunities for people to have experiences that change their understanding and perspective of the world they live in.

REICH+PETCH

1867 Yonge Street Toronto, ON Canada M4S 1Y5
TEL (416) 480 2020 FAX (416) 480 1881
www.reich-petch.com
info@reich-petch.com